

TECHNOLOGY IN MOTION

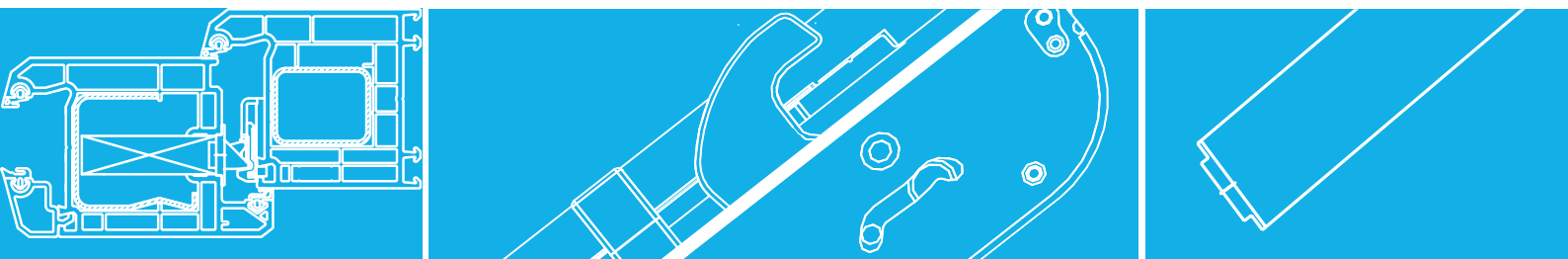

**MACO  
PROTECT**  
DOOR LOCKS



LEVER OPERATED HOOK / HOOK-BOLT  
COMBINATION TOP-HAT FACEPLATE  
single and double door locks PVC

ASSEMBLY INSTRUCTIONS

## Legend

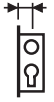

Backset - BS



Spindle Centre - SC



Handle Height - HH



Cutting Range



Profile Front Face

Hook-Bolt

Hook-Bolt Combination

Hook

Hook Locking

Bolt

Bolt Locking

**MACO  
PROTECT**



## Contents

Instructions for Transportation	4
Installation Instructions	5
Latch Reversal	8
Lockcase Dimensions	9
Striker Routing Details	12
Striker Plate Positions	15

## Transportation Instructions

For safety during transportation it is recommended that spacer blocks or run up wedges are fitted to prevent the sash from moving.

If run up wedges are fitted it is good practice to leave them in place following the installation of the door.

- (A) Positions for transport blocks.

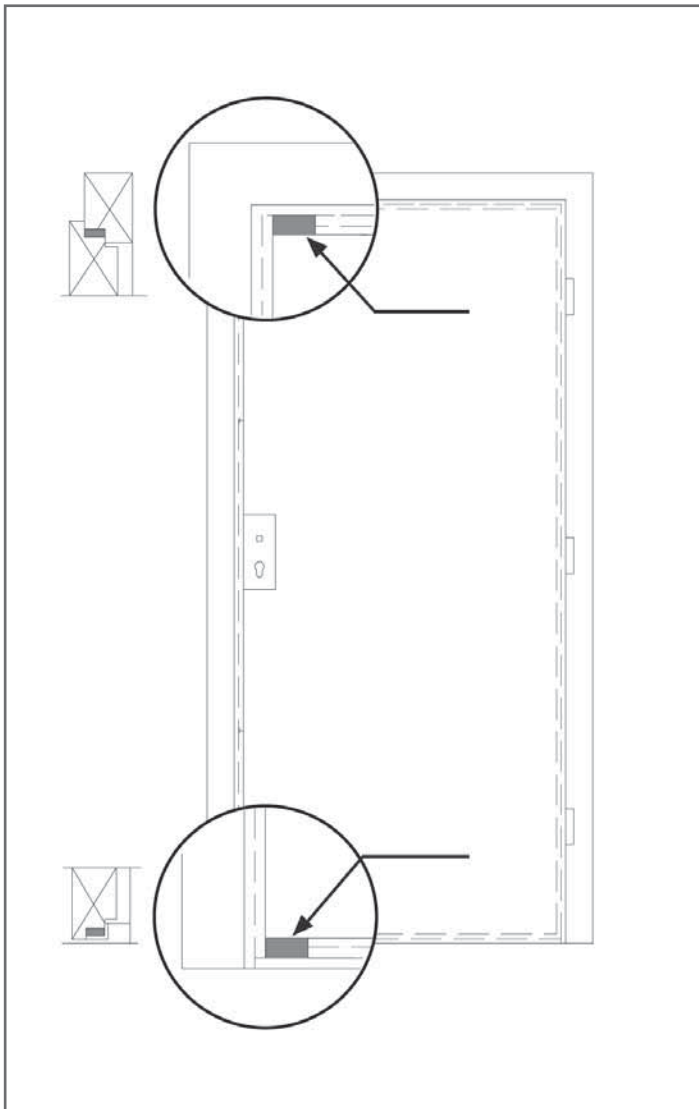

**Installation Instructions**

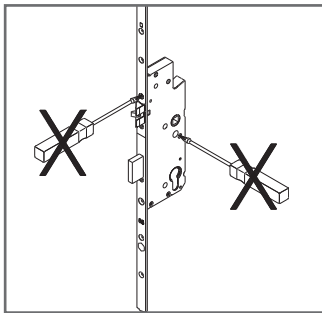

① The lockcase must not be opened!

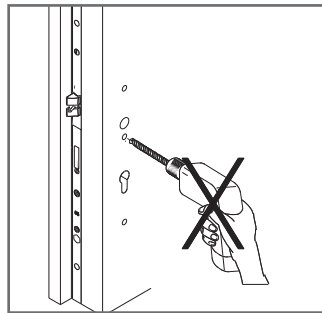

② All routing and drilling must be completed before the lock is fitted!

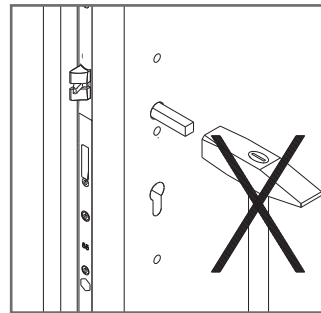

③ Do not force the spindle bar through the lockcase!

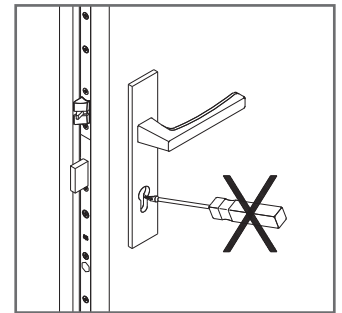

④ The lockcase must only be operated by a suitable key!

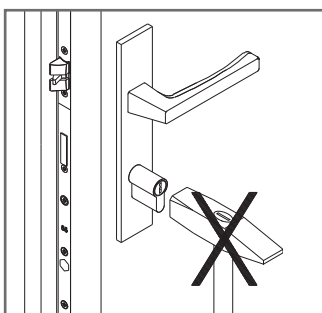

⑤ Do not apply force when fitting the profile cylinder!

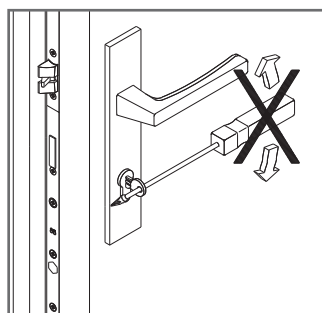

⑥ Do not apply force through external leverage in order to turn the key!

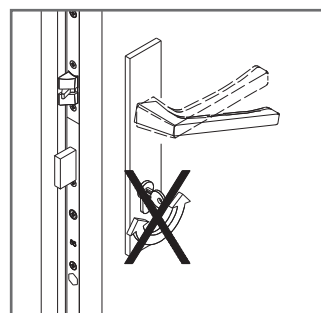

⑦ Do not operate the handle and key at the same time!

**Installation Instructions**

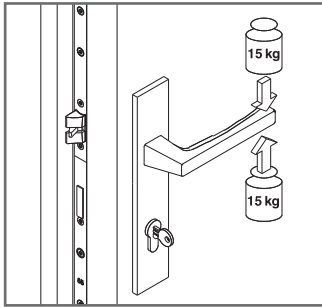

① The handle operates in a vertical movement (max force 15Kg) to operate!

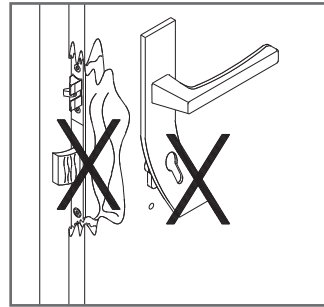

② Any damaged components must be replaced.

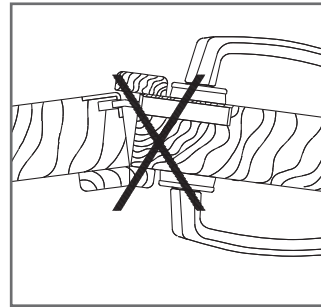

③ On double doors the active door must be operated before the slave door!

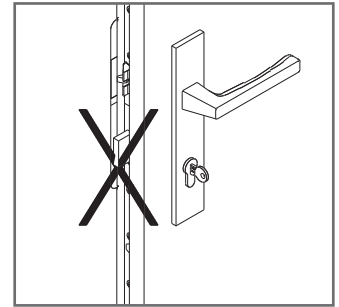

④ The dead bolt must not be thrown when the door is open!

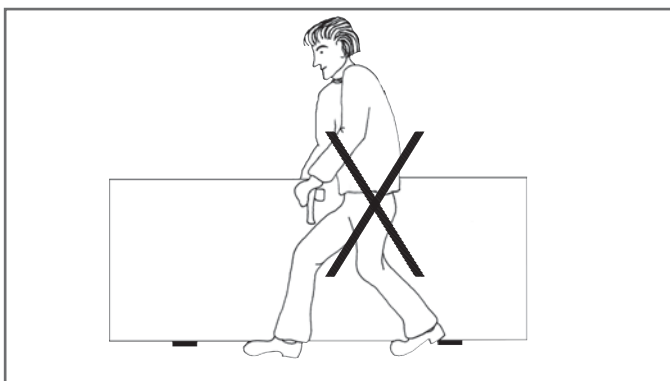

⑤ The door must not be carried by the handle set!

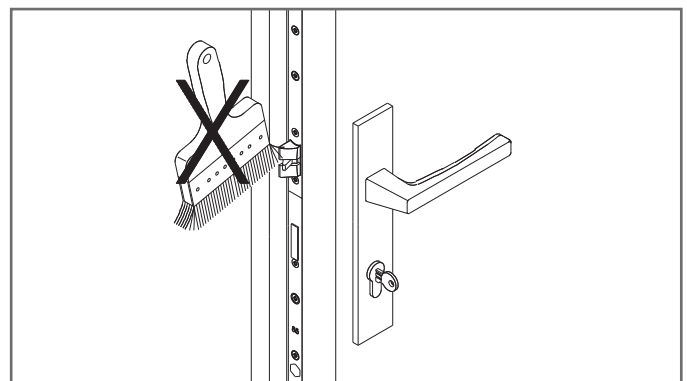

⑥ Do not paint or lacquer any part of the lock!

## Installation Instructions

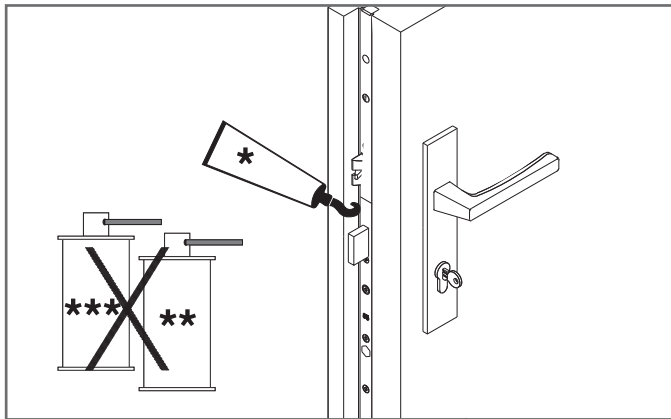

- \* Petroleum Jelly
- \*\* Anti Rust Spray
- \*\*\* Silicone Spray



No lubricating oils, Anti Rust or Silicone Sprays etc should be used!

- ① The central lockcase is supplied with a permanent high quality lubricant and does not require further lubrication!
- Latch and Deadbolt requires lubrication once a year.

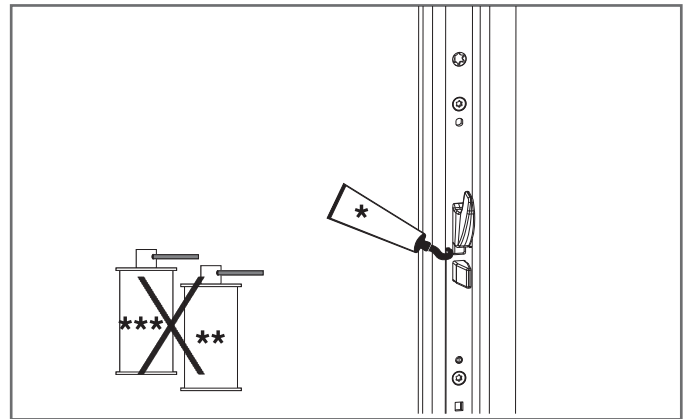

- ② Hook-Bolt, Hook, Bolt requires lubrication once a year.



Lubricate with a light grease such as a petroleum jelly.

## Installation Notes

### Latch Reversal

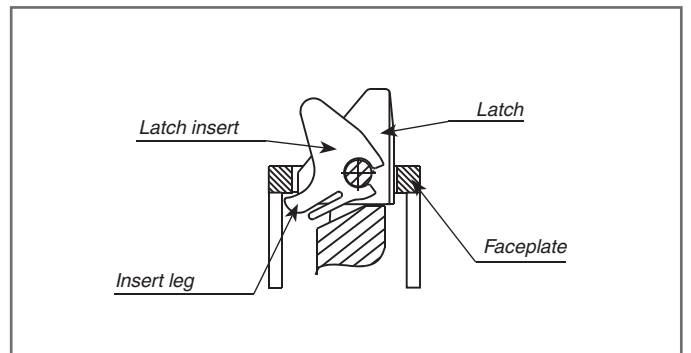
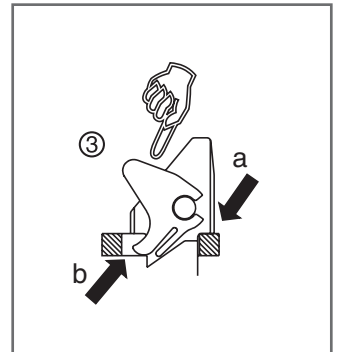
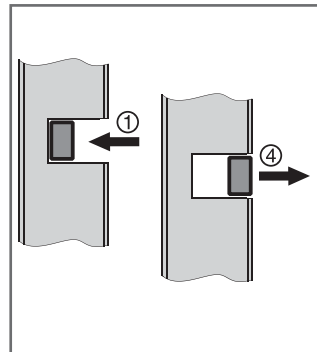
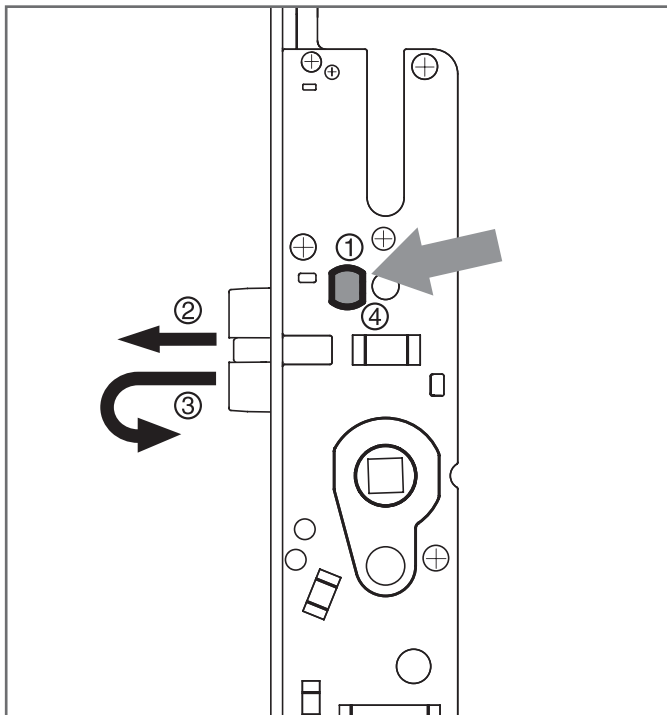

① Push the button.

② Remove the latch.

③ Reverse the latch and replace it into the faceplate slot (a). Ensure that the leg of the latch insert locates under the faceplate (b). Then push the latch fully in.

④ Ensure that the button fully returns.





## Installation Notes

### Positioning the latch and dead bolt strike.

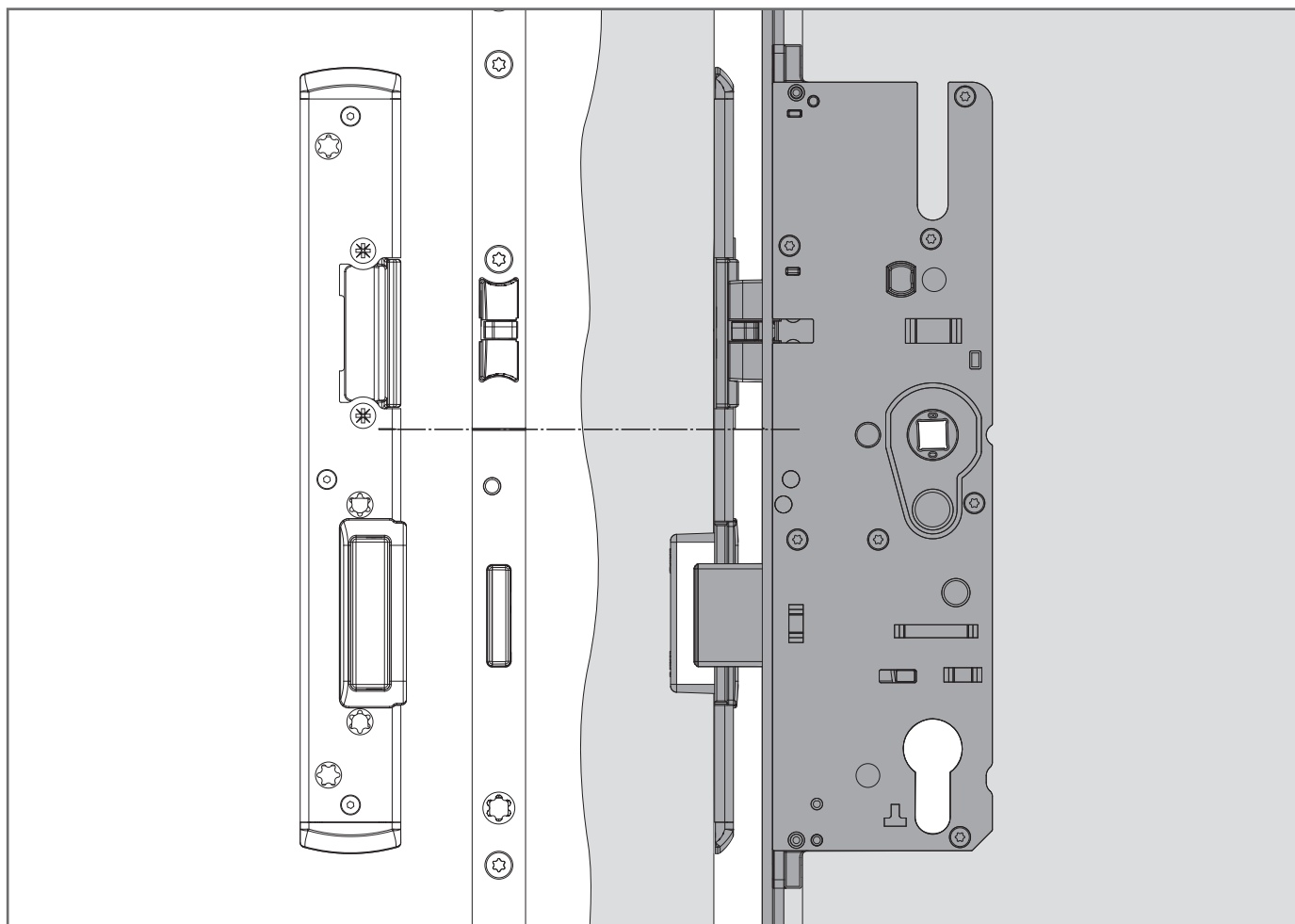

Gasket compression adjustment +/- 1 mm

Location

Faceplate Centre Line = Latch

Plate Centre Line

## Installation Notes

### Positioning Hook- Bolt-Striker

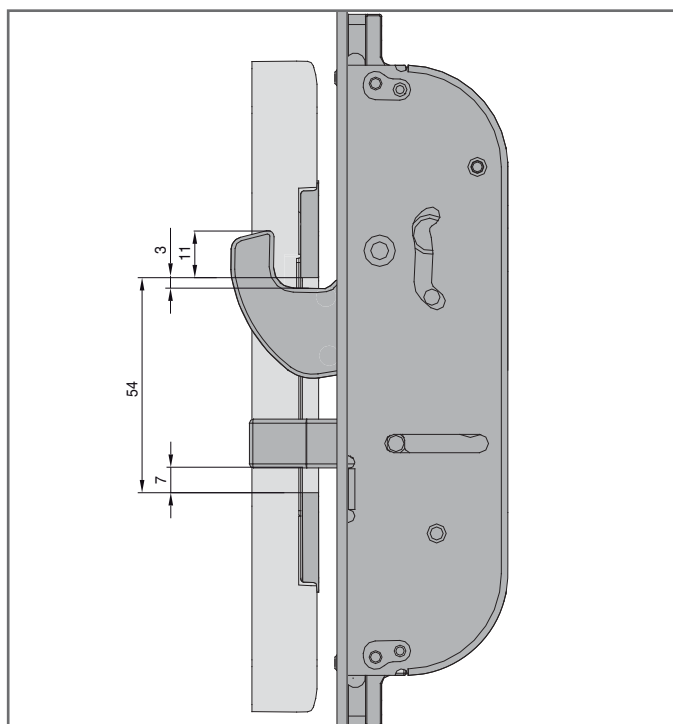
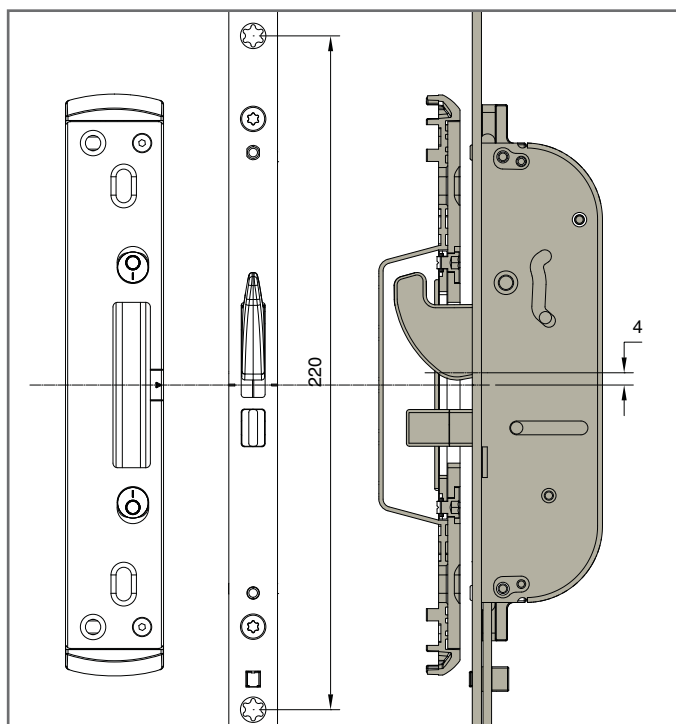

Gasket compression adjust-  
ment +/- 1.5 mm

Location

Faceplate Centre Line = Top

Hook Strike Centre Line

Routing Detail

Lockcase Machining

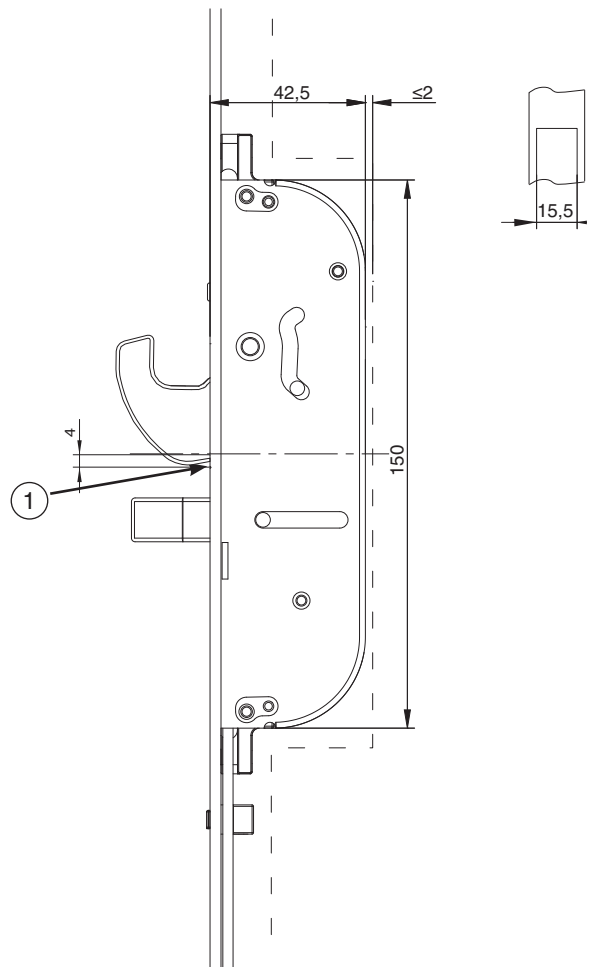
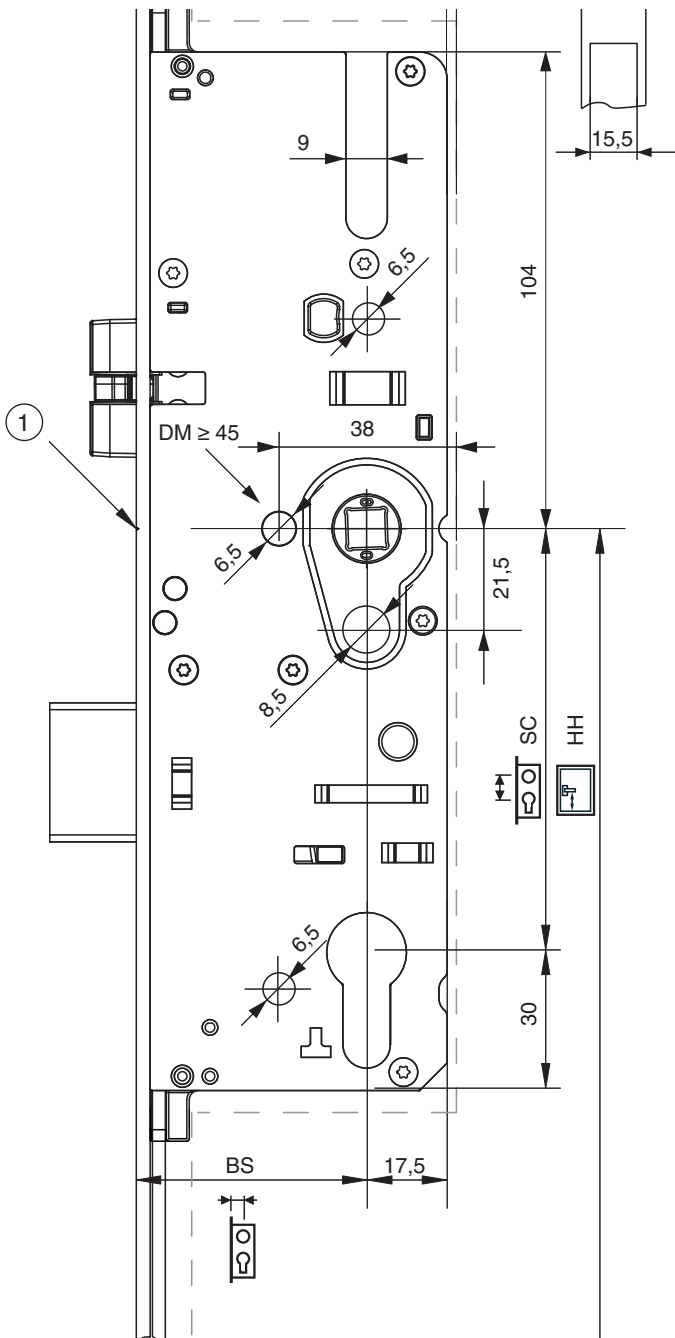

- ① Faceplate Centre Line
- ② Eurogroove

Routing and Drilling

- ① Latch and Dead Bolt Strike
- ② Hook-Bolt Striker

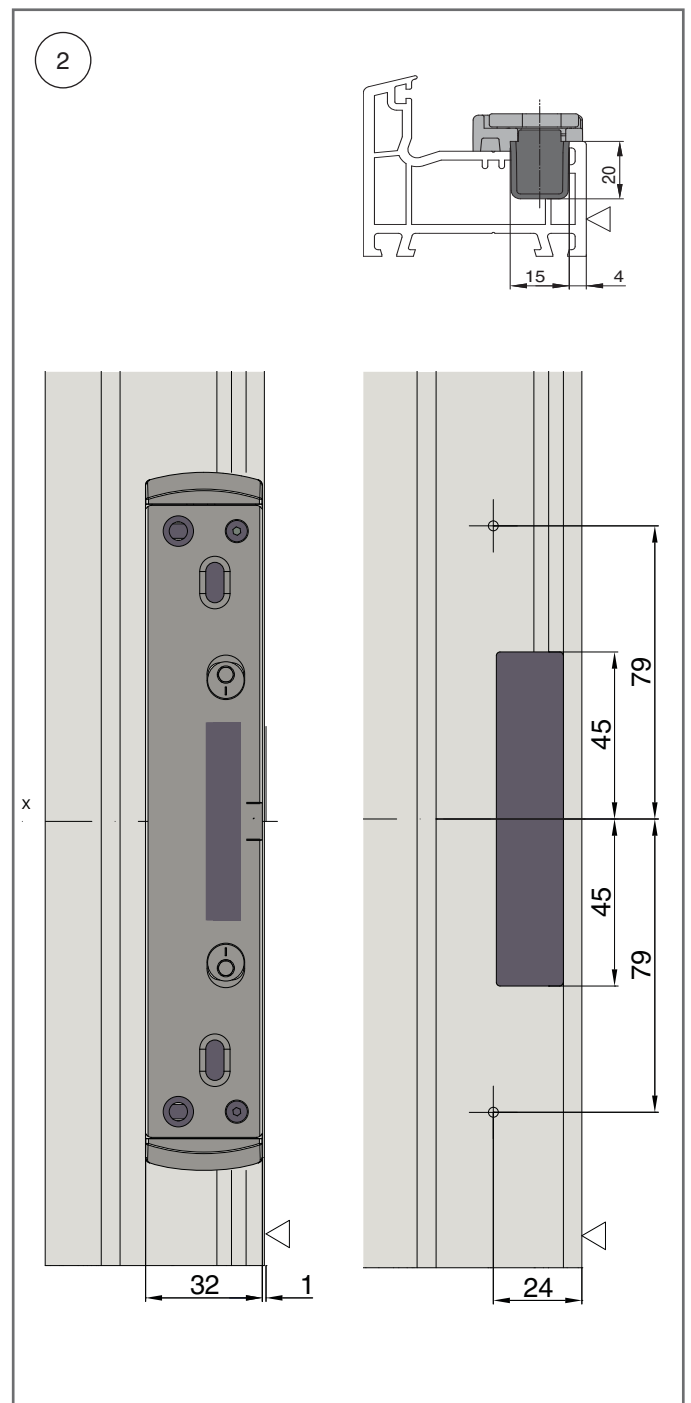
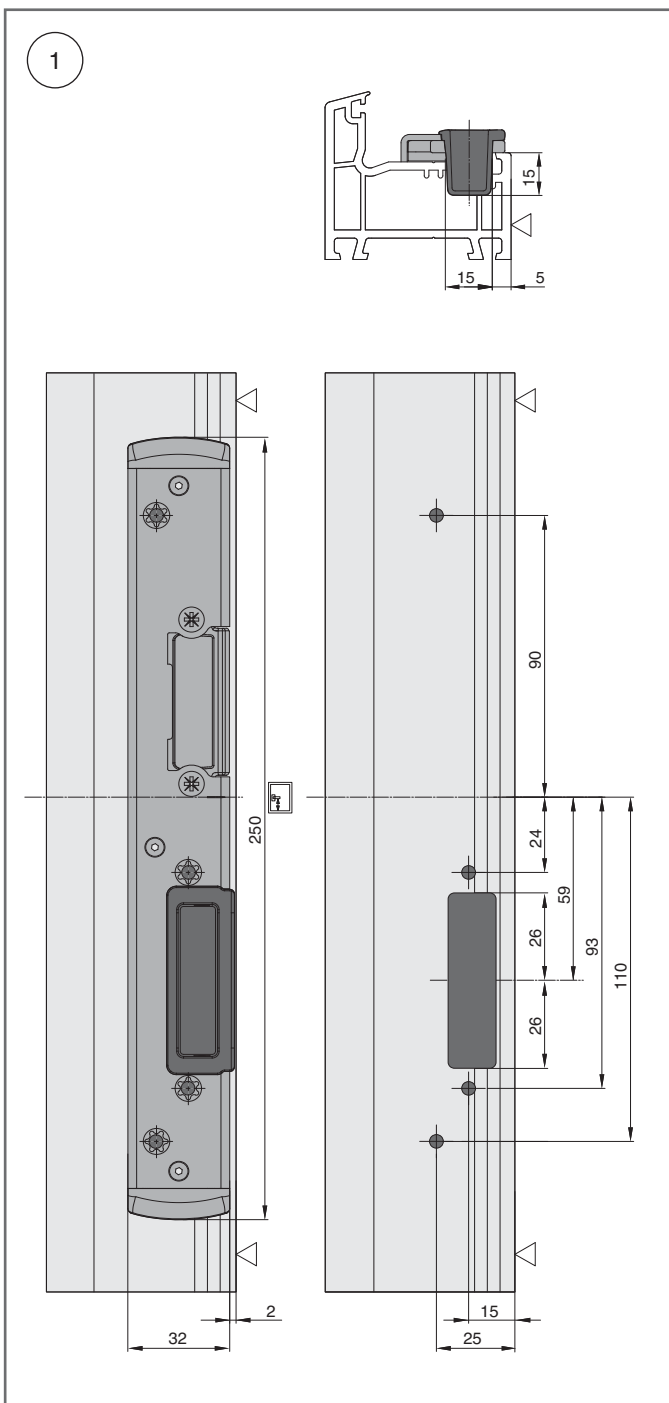

Routing and Drilling

③ Double Slot Shootbolt Striker

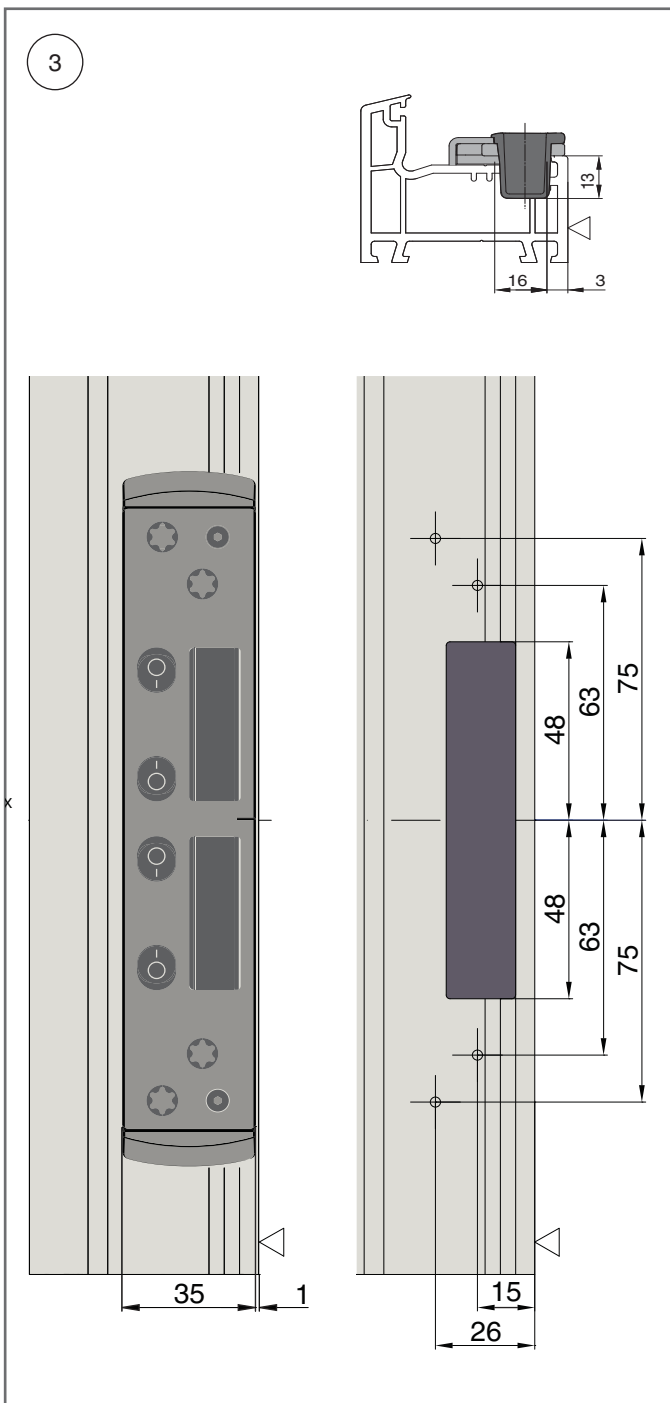

### Lockcase Routing Positions

- ① 2 Hook, 2 i.S.
- ② 2 Hook-Bolt, 2 i.S.
- ③ 2 Hook
- ④ 2 Hook-Bolt

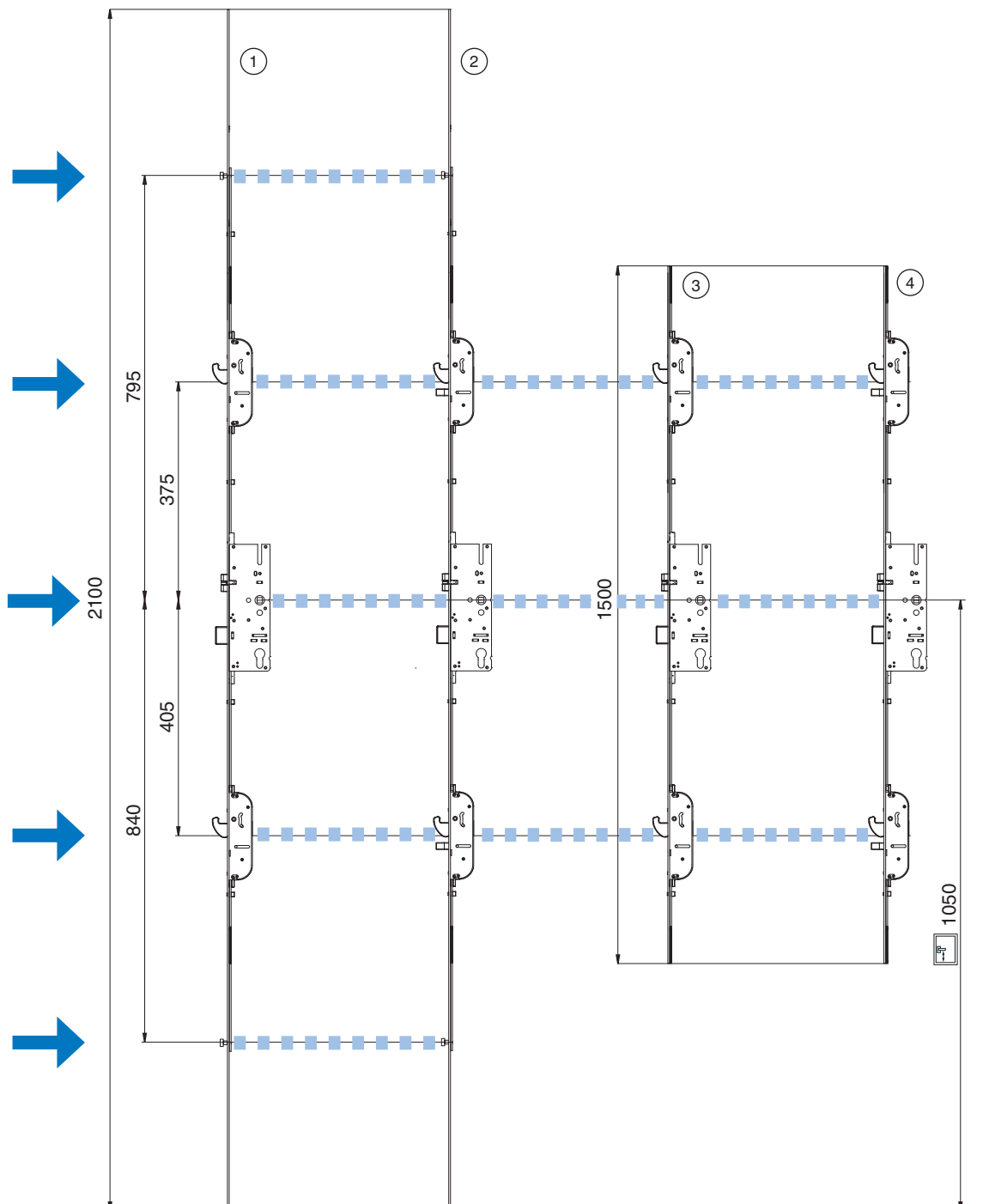



**Striker Plate Positions**

- ① **2 Hook, 2 i.S.**
- ② **2 Hook-Bolt, 2 i.S.**
- ③ **2 Hook**
- ④ **2 Hook-Bolt**

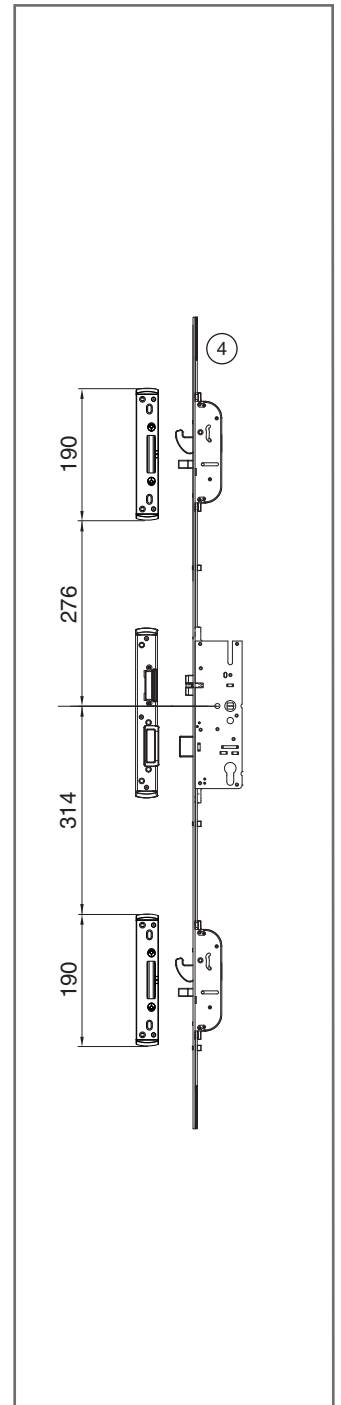
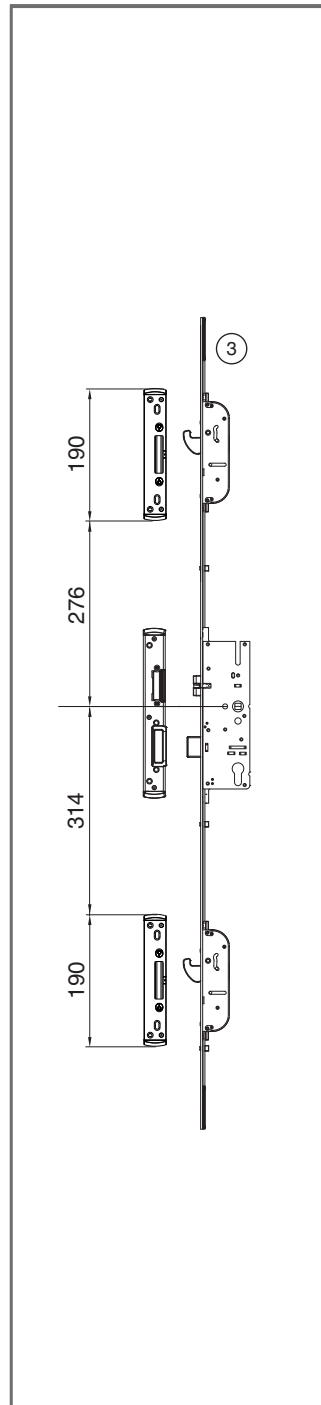
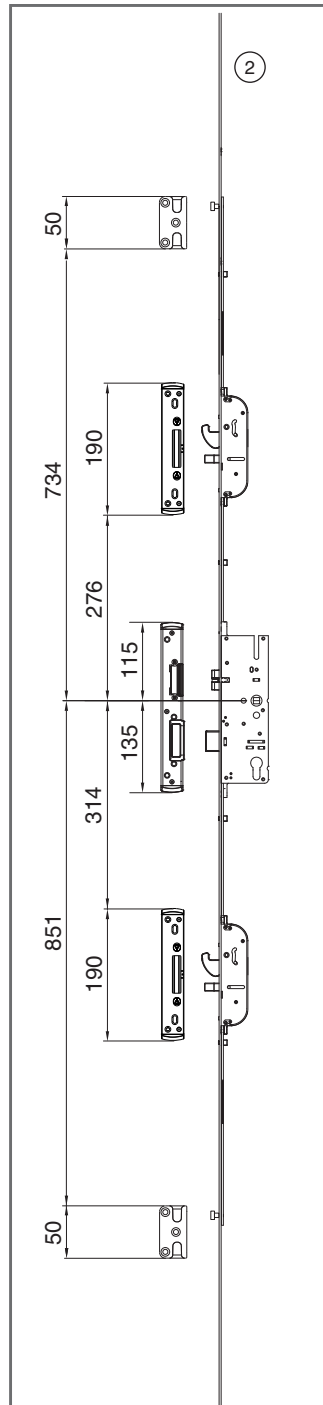
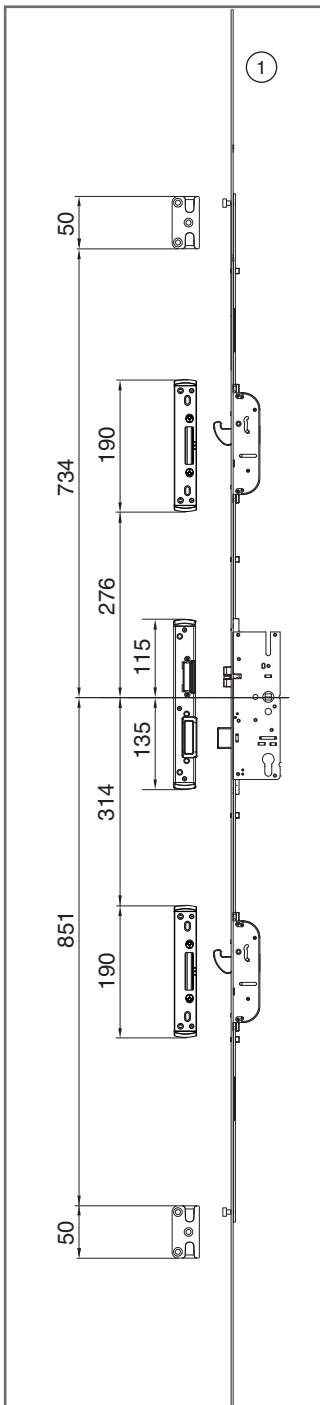

**MACO  
PROTECT**



**MACO DOOR & WINDOW  
HARDWARE (U.K.) LTD**  
EUROLINK INDUSTRIAL CENTRE  
CASTLE ROAD  
SITTINGBOURNE  
KENT, ME10 3LY  
TEL +44 (0)1795 433900  
FAX +44 (0)1795 433901  
enquiry@macouk.net  
www.macouk.net

Order-THASSIN - Date: June 2010  
All rights reserved and subject to change.